

Approximate Gross Internal Area = 130.3 sq m / 1402 sq ft
Store = 9.5 sq m / 102 sq ft
Total = 139.8 sq m / 1504 sq ft

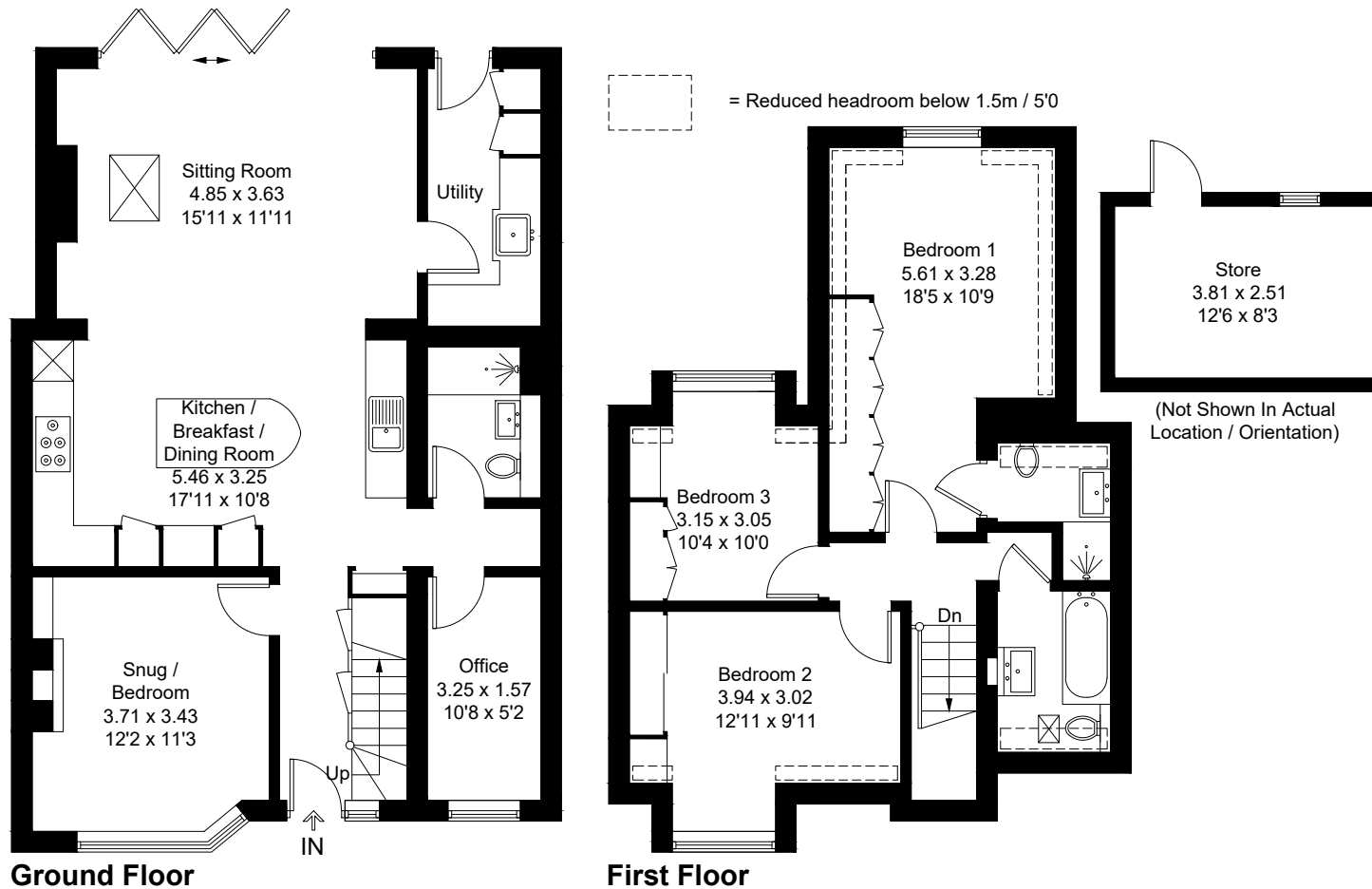

Created by **BAY TREE ESTATES - Telephone 01243 850451.**

These plans are for representation purposes only as defined by RICS - Code of Measuring Practice. Not to scale.(ID1293989)