

Approximate Gross Internal Area = 73.5 sq m / 791 sq ft  
Garage = 13.0 sq m / 140 sq ft  
Total = 86.5 sq m / 931 sq ft

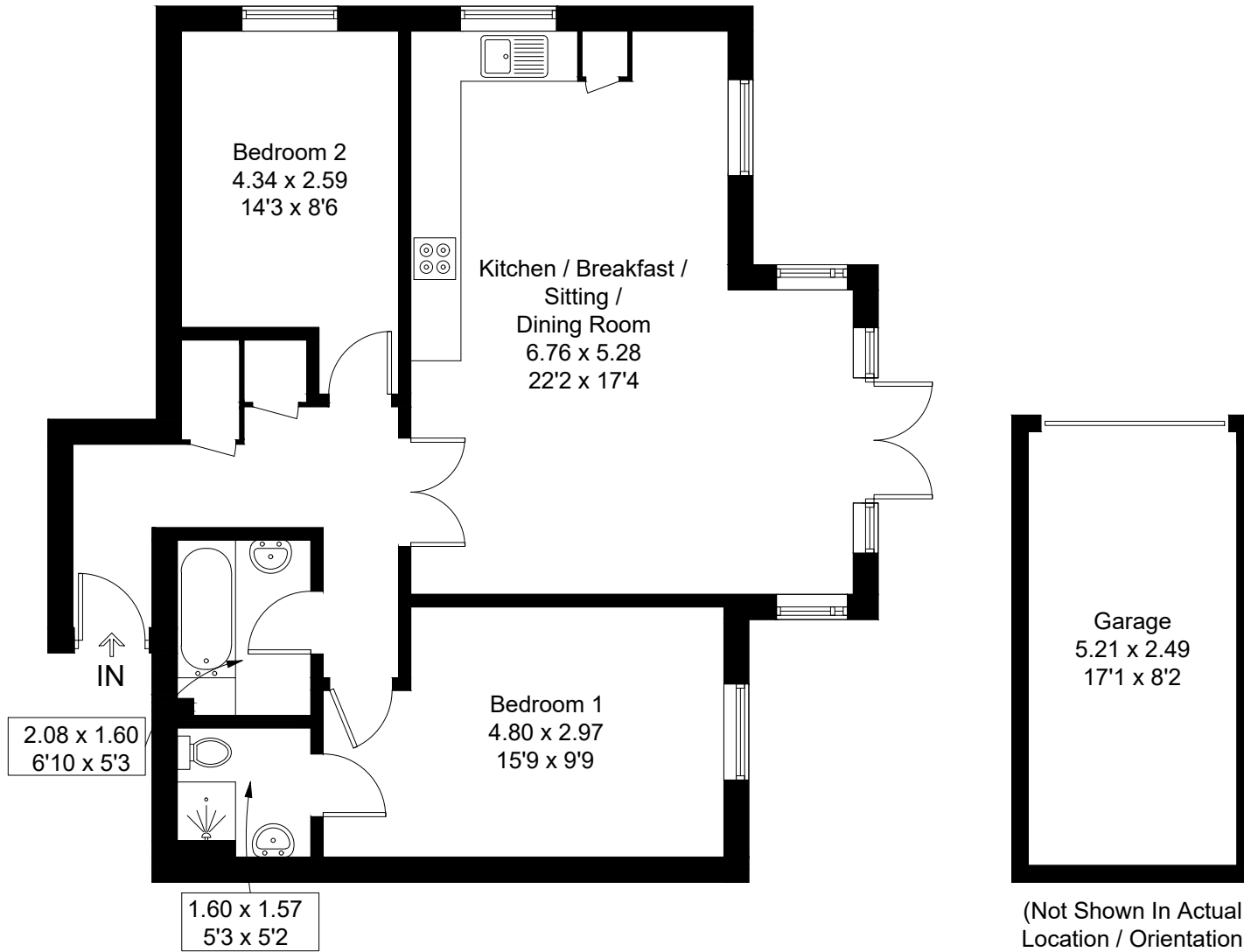
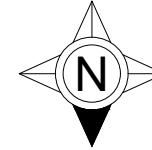

## Ground Floor

Created by **BAY TREE ESTATES - Telephone 01243 850451.**

These plans are for representation purposes only as defined by RICS - Code of Measuring Practice. Not to scale.(ID1308466)